

# Insulated Steel Building

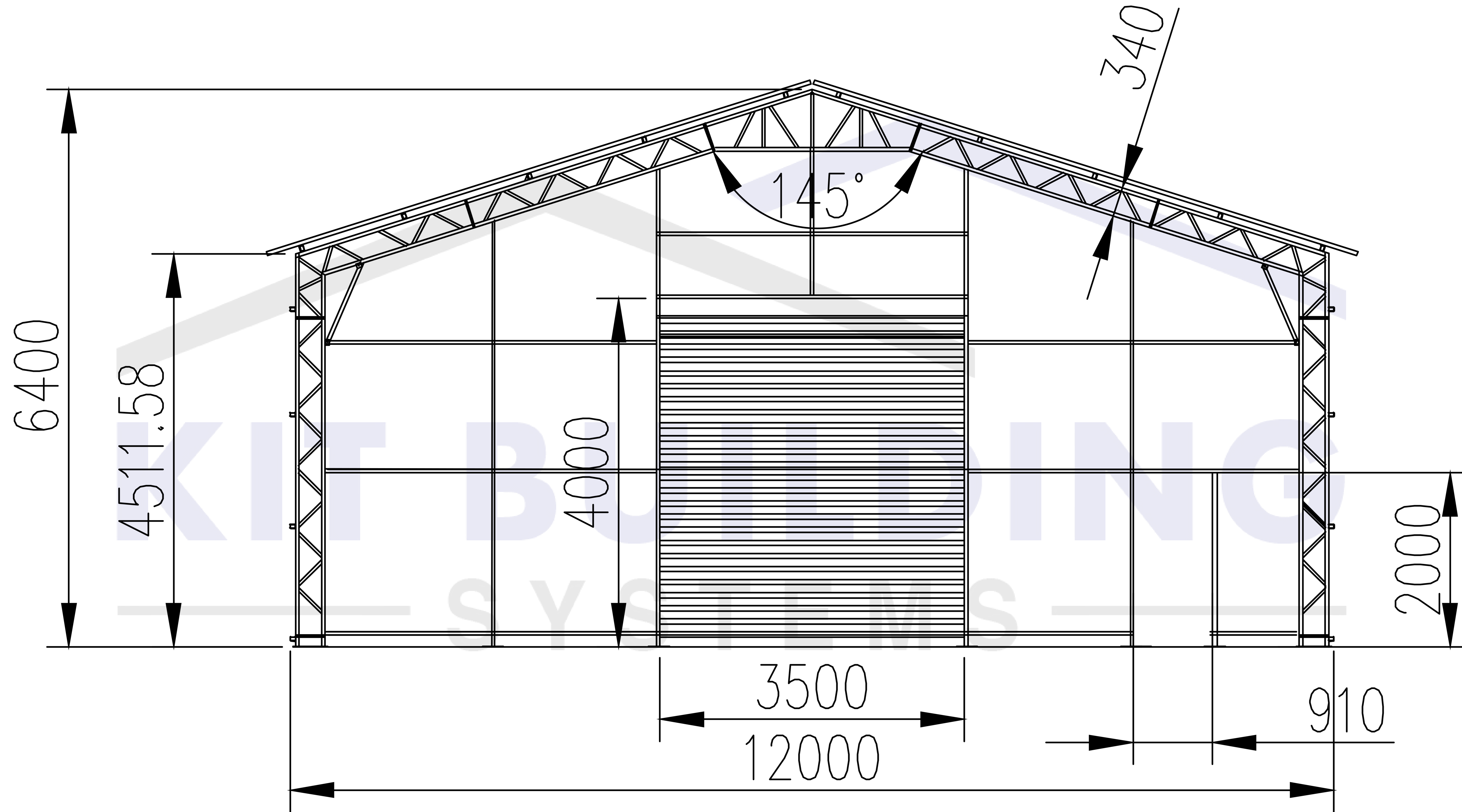

**PROJECT TITLE**

Insulated Steel Building

**NOTES**

**WORKING DRAWING**

**DRAWING BY:** Izzi Grigg

**PROJECT:** Standard Building

**SCALE N.T.S** 13.08.2025

Length: 20m | 66'  
 Width: 12m | 40'  
 Eave Height: 4.5m | 15'  
 Overall Height: 6.4m | 21'  
 Arch Distance: 2.5m | 8.2'  
 Opening Clearance: 4m | 13'

**REVISIONS**

Sr.	DESCRIPTION	DATE

Steel Frame: RHS Double Truss	Covering: 50mm Insulated Sandwich Panels	Arch Tube Thickness: 60mm x 40mm x 2mm   2.36" x 1.57" x 0.08"	Purling Tube Thickness: 60mm x 40mm x 2mm   2.36" x 1.57" x 0.08"	Eave Height: 4.5m   15'	Opening/Shutter Size WxH: 3.5m x 4m   11.5" x 13'
Front Gabel End Elevations			Shutter Type: Electric Roller Shutter	Pedestrian door WxH Material: Coated Steel 2m x 0.9m	PAGE 1 OF 3

# Insulated Steel Building

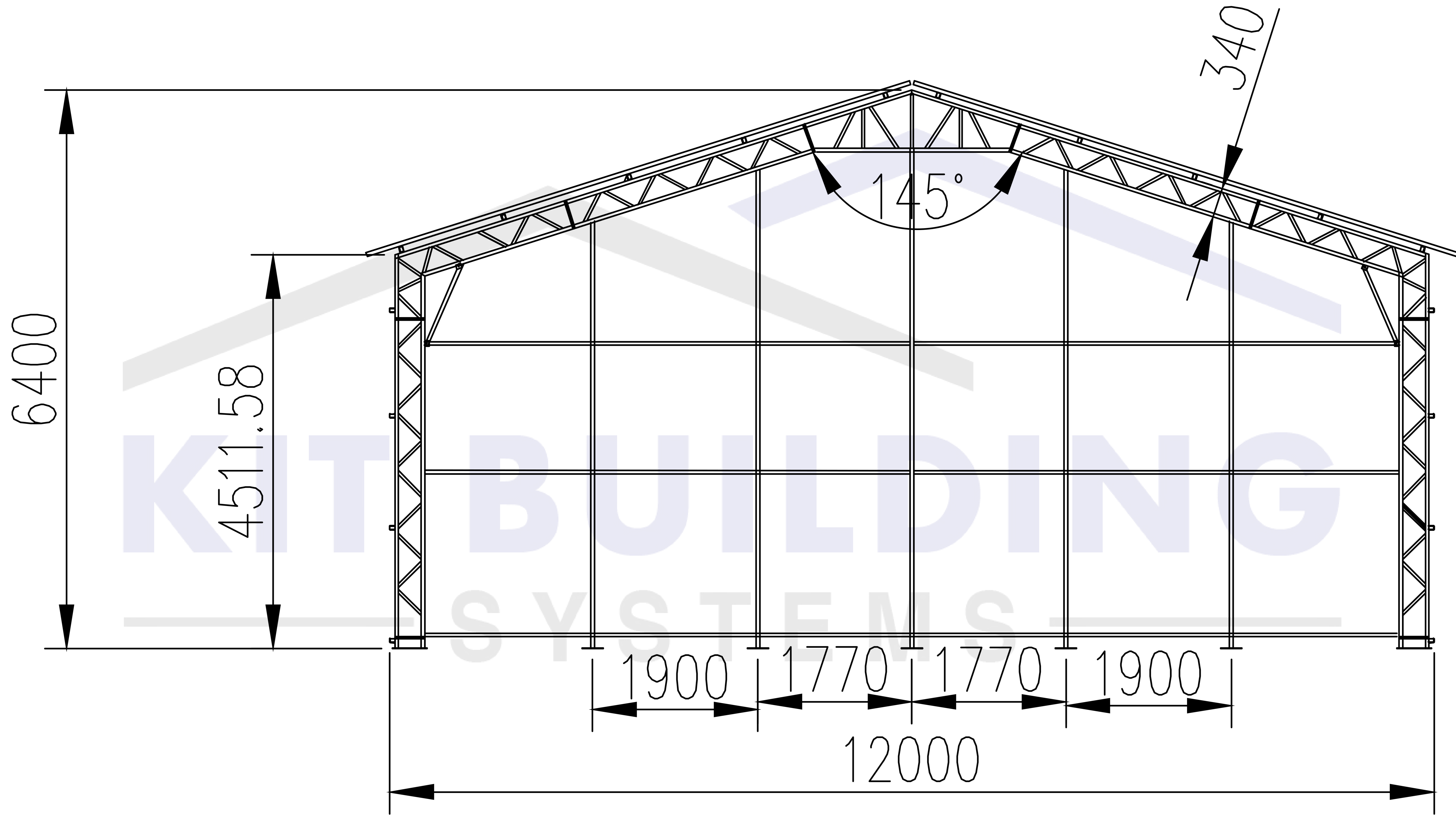

**PROJECT TITLE**

Insulated Steel Building

**NOTES**

**WORKING DRAWING**

**DRAWING BY:** Izzi Grigg

**PROJECT:** Standard Building

SCALE N.T.S 13.08.2025

Length: 20m | 66'  
 Width: 12m | 40'  
 Eave Height: 4.5m | 15'  
 Overall Height: 6.4m | 21'  
 Arch Distance: 2.5m | 8.2'  
 Opening Clearance: 4m | 13'

**REVISIONS**

Sr.	DESCRIPTION	DATE

Steel Frame: RHS Double Truss	Covering: 50mm Insulated Sandwich Panels	Arch Tube Thickness: 60mm x 40mm x 2mm   2.36" x 1.57" x 0.08"	Purling Tube Thickness: 60mm x 40mm x 2mm   2.36" x 1.57" x 0.08"	Eave Height: 4.5m   15'	Opening/Shutter Size WxH: 3.5m x 4m   11.5" x 13'
Front Gabel End Elevations				Shutter Type: Electric Roller Shutter	Pedestrian door WxH Material: Coated Steel 2m x 0.9m

**KIT BUILDING**  
 — SYSTEMS —  
 WWW.KITBUILDINGS.COM

PAGE 2 OF 3

# Insulated Steel Building

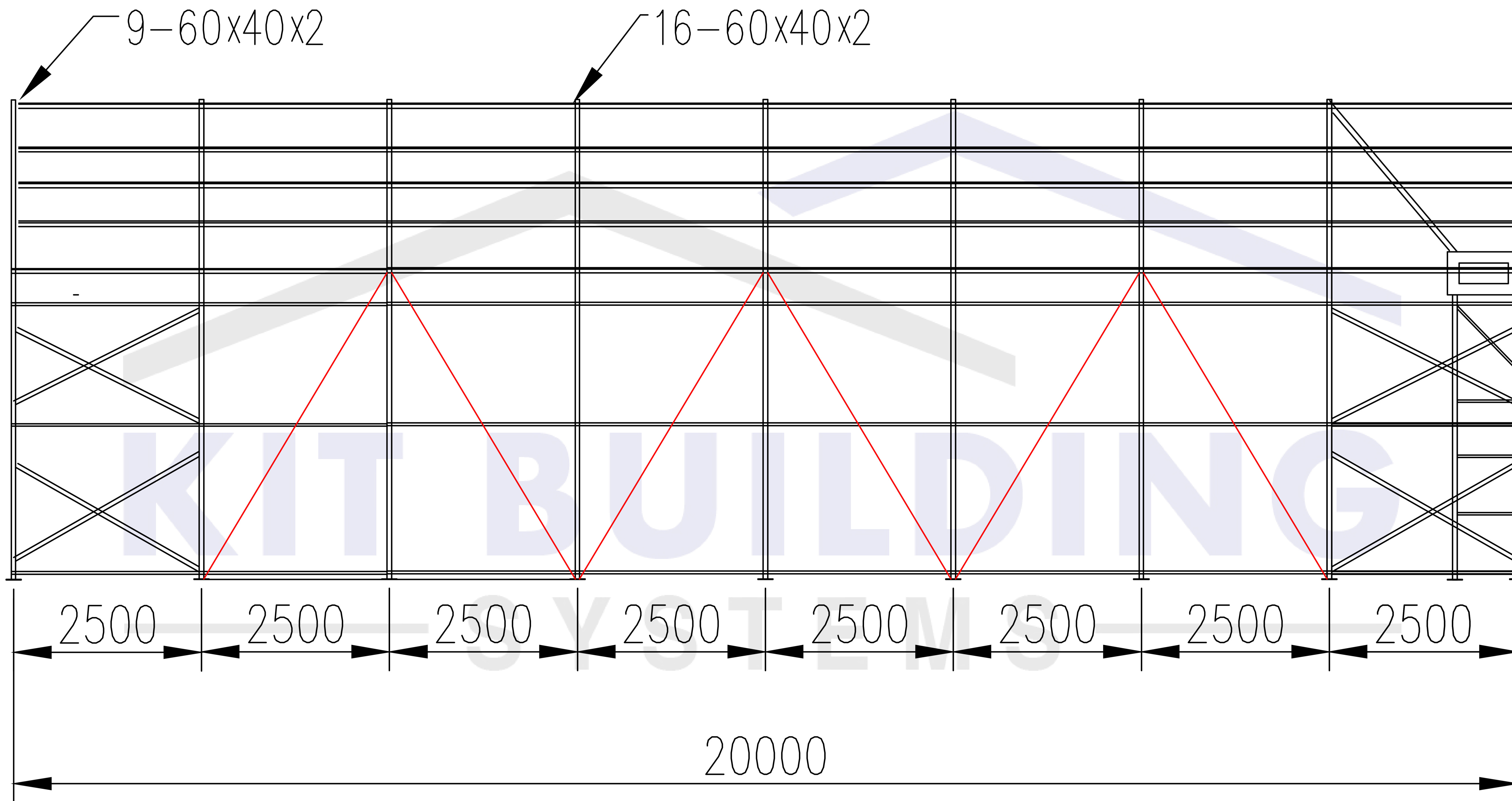

**PROJECT TITLE**

Insulated Steel Building

**NOTES**

**WORKING DRAWING**

**DRAWING BY:** Izzi Grigg

**PROJECT:** Standard Building

**SCALE N.T.S** 13.08.2025

Length: 20m | 66'  
 Width: 12m | 40'  
 Eave Height: 4.5m | 15'  
 Overall Height: 6.4m | 21'  
 Arch Distance: 2.5m | 8.2'  
 Opening Clearance: 4m | 13'

REVISIONS		
Sr.	DESCRIPTION	DATE

Steel Frame: RHS Double Truss	Covering: 50mm Insulated Sandwich Panels	Arch Tube Thickness: 60mm x 40mm x 2mm   2.36" x 1.57" x 0.08"	Purling Tube Thickness: 60mm x 40mm x 2mm   2.36" x 1.57" x 0.08"	Eave Height: 4.5m   15'	Opening/Shutter Size WxH: 3.5m x 4m   11.5" x 13'
Front Gabel End Elevations				Shutter Type: Electric Roller Shutter	Pedestrian door WxH Material: Coated Steel 2m x 0.9m